

KILIÇ MARINA BEYLİKDÜZÜ

TURKEY / ISTANBUL / BEYLİKDÜZÜ

Project Status:
Completed

Price Range:
9,904,000 - 9,904,000 TL

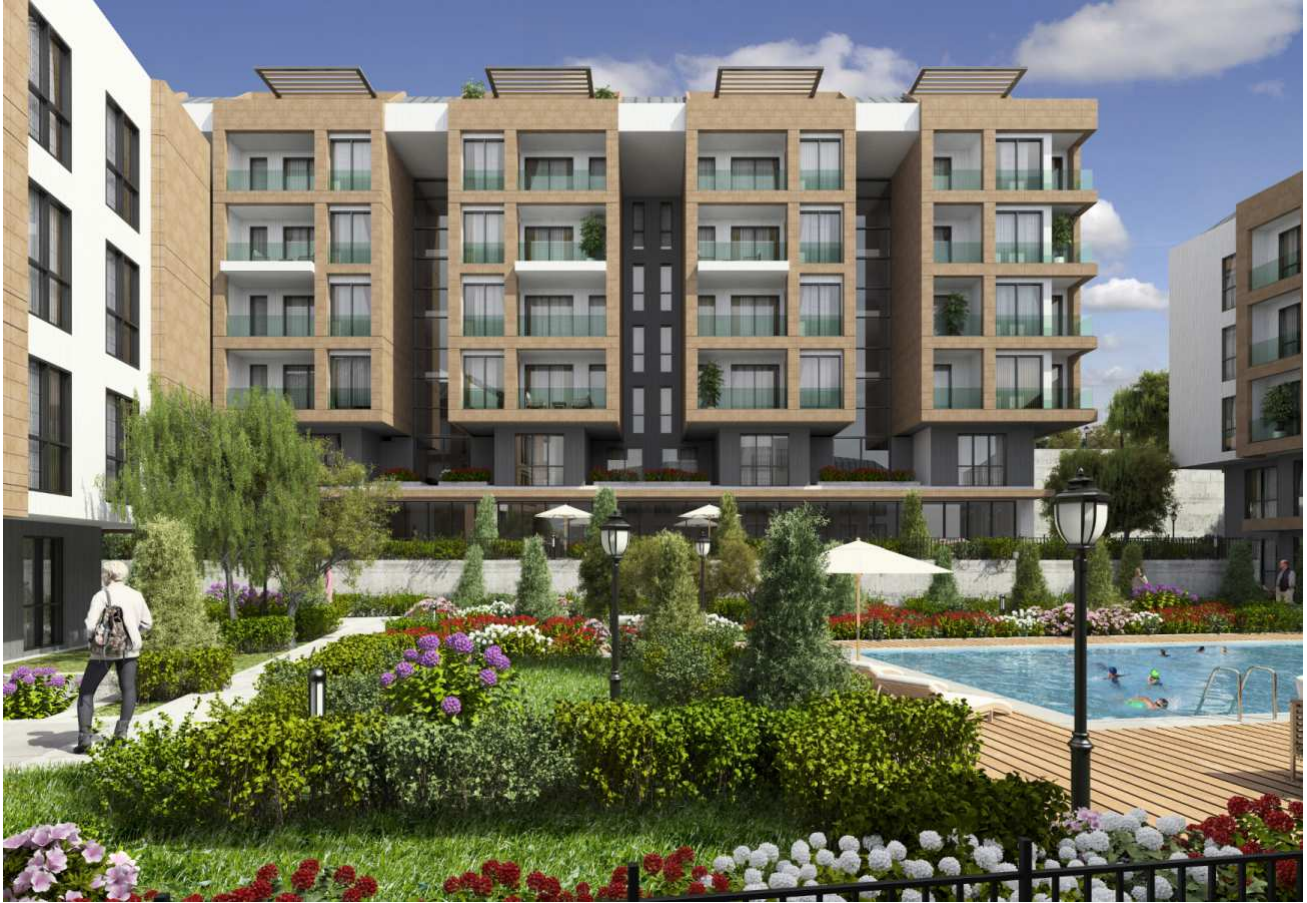

New | For Investment | Appropriate for Credit |

Investment Properties | Distressed Properties |

Indoor/Covered Area (m²) : 8,000

Open Area (m²) : 10,800

Block Number : 13

Land m² : 18,000

LOCATION :

Near to Street, Near to E5 Haighway, Close to Minibus Route, Close to Coast,

ENVIRONMENT :

Shopping Center, Gas Station, Drugstore, Drugstore / Medical, Entertainment Center, Hospital / Health facility, Nursery, Coiffure & Beauty Center, High School, School (Education facility), Patisserie & Bakery, Polyclinic, Police Station, Post Office, Restaurant, Health Center, District Bazaar, Veterinary, Dry-Cleaning,

INFRASTRUCTURE :

Earthquake Regulation Proof, Earthquake Resistant, Ground Survey,

COMPOUND :

Security, Pressure Tank, Generator-Power Unit, Doorman, Parking - Outdoor, Parking - Indoor, Meeting Room, Satellite Broadcast, Carry Lift/Elevator, Security System, Indoor Garrage, Suitable for Disabled, Fire Alarm, Security Camera,

CONSTRUCTION PROPERTIES :

Built-in White Goods Kitchen, Heat Proofing, Fire ladder, Reinforced Concrete,

SCENERY :

Sea View, Close to Marine Transportation,

FACILITY ACTIVITIES :

Children Swimming Pool, Gym, Jogging / Walking Areas, Swimming Pool, Swimming Pool (Indoor), Turkish Hammam, SPA,

Product Documents

[5_2_last_floor_300_68m2.pdf](#) |

ESTATE TYPES



9,904,000 TL

331 m² , 5 + 2

For Sale, Apartment





NEW MARINA
BEYLİKDÜZÜ KAVAKLI
SEA VIEW
List price 9.904.000 TL
Cash price 8.913.000 TL



5-2 331 M2

- Duplex
- 2 Balconies 2 of them with sea view
- Suitable for citizenship and outsiders permit
- 4mins from WEST ISTANBUL MARINA