

## Zeray Dilasa Orman - 4+1 س ك ل ب و د 4+1 Kocaeli / Başiskele

375,000 \$ | 261 m2 Kocaeli / Başiskele



فرغ ال دد : 4  
نول اصل ال دد : 1  
تام اصل ال دد : 1  
لكي هل ا غون : ن ق با ط ة ق ي د ح  
ة ل و د ل ا ل ك ي ه : ة د ي د ج ة ر ا ج ت ة م ا ل ع  
م ا د خ ت س ا ل ا ع ص و : غ ر ا ف



İsmail Can

Phone +90 542-811 80 80

Mobile Phone +90 542-811  
80 80

REALTY GALAXY

Phone +90 542-811 80 80

Mobile Phone +90 533-382  
39 79

Fax +90 212-855 74 75

Yavuz Sultan Selim Bulvarı

Büyüçekmece /

Büyüçekmece

34528 , Istanbul

Advert No:f-494589-1153



Advert No:f-494589-1153



Advert No:f-494589-1153

**4+1**  
10 NOLU DAİRE

BAHÇE DUBLEKS DAİRE  
ALT KAT  
GARDEN DUPLEX APARTMENT GROUND FLOOR



BAHÇE DUBLEKS DAİRE  
ÜST KAT  
GARDEN DUPLEX APARTMENT GROUND FLOOR



A BLOK 10 NOLU DAİRE

1	SALON LIVING ROOM	: 37.60 m <sup>2</sup>
2	MUTFAK KITCHEN	: 18.00 m <sup>2</sup>
3	YATAK ODASI BEDROOM	: 11.70 m <sup>2</sup>
4	WC WC	: 1.70 m <sup>2</sup>
5	ANTRE ENTRANCE	: 4.70 m <sup>2</sup>
6	TERAS TERRACE	: 48.60 m <sup>2</sup>
7	YATAK ODASI BEDROOM	: 15.60 m <sup>2</sup>
8	YATAK ODASI BEDROOM	: 26.90 m <sup>2</sup>
9	EBV. BANYO BATHROOM	: 3.90 m <sup>2</sup>
10	YATAK ODASI BEDROOM	: 11.60 m <sup>2</sup>
11	BANYO BATHROOM	: 7.10 m <sup>2</sup>
12	HOL HALL	: 7.00 m <sup>2</sup>
13	BALKON BALCONY	: 23.50 m <sup>2</sup>

TOPLAM BRÜT ALAN : 261.40M<sup>2</sup>  
TOTAL GROSS AREA

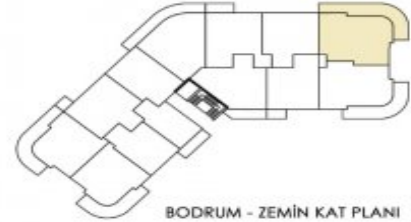

BODRUM - ZEMİN KAT PLANI